



PLUG-IN TR TUBE

Service Type CV6129

The data should be read in conjunction with the Duplexer Device Preamble.

DESCRIPTION

Plug-in, primerless TR tube.

CHARACTERISTICS (See note 1)

Frequency range	2600 to 3950	MHz
Centre frequency (see note 2)	3600 to 3645	MHz
V.S.W.R. (see note 3)	1.12:1	max
Maximum leakage		
spike energy (see note 4)	1.0	μ J/pulse
high power total (see note 5)	3.6	W
low power	10	W
Attenuation recovery period to 3db (see note 5)	30	μ s max
Insertion loss (see note 3)	0.2	db max

MAXIMUM AND MINIMUM RATINGS

	Min	Max	
Transmitter power (peak)	0.01	5.0	kW
Transmitter power (mean)	—	5.0	W
Ambient temperature (non-operating)	-40	+100	$^{\circ}$ C

GENERAL

Overall dimensions	see Outline
Finish	metal parts silver or nickel plated
Mounting position	any
Net weight	120g (4.2 ounces) approx

NOTES

1. The tube is designed for use in a no. 10 or no. 11 waveguide mount. The frequency and performance characteristics depend on the design of the mount, which should have a loaded Q of 6.0 max. with the tube installed.
2. The geometric mean of the frequencies at which the v.s.w.r. is 1.33:1.
3. Measured at a low power level, at 3620MHz.
4. Measured at 5.0kW peak power, 0.1 μ s pulse length and 1000p.p.s.
5. Measured at 5.0kW peak power, 1.0 μ s pulse length and 1000p.p.s.

OUTLINE

3228

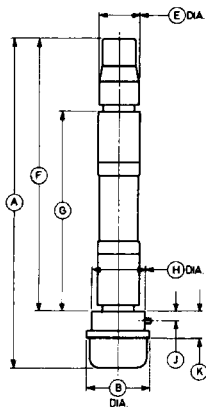
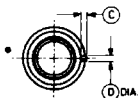

Ref	Millimetres	Inches
A	132.0 ± 5.0	5.197 ± 0.197
B	25.40 max	1.000 max
C	1.40 ± 0.13	0.055 ± 0.005
D	1.40 ± 0.13	0.055 ± 0.005
E	15.85 max	0.624 max
	15.77 min	0.621 min
F	112.0 max	4.409 max
G	82.4 ± 0.9	3.244 ± 0.035
H	21.50 ± 0.05	0.846 ± 0.002
J	3.95 ± 0.15	0.156 ± 0.006
K	11.0 ± 0.3	0.433 ± 0.012

Inch dimensions have been derived from millimetres.